

**Lincolnshire Longwool Sheep by Sally Matthews** near Stixwould  
Water Rail Way - National Cycle Network – route 1, Lincolnshire



**Lincolnshire Red Cattle by Sally Matthews** – near Bardney



Alchemic Garden  
by Sally and David Ashton Hill

This is a site specific sculptural garden, the selected area is along the banks of the River Witham, OS map reference TF 011 709. Its purpose is to mark a place along the cycle path where people can stop and reflect on the particular nature of the place chosen. The sculptural forms are intended to educate and also to intrigue and their design is rich with historic reference.

There are three distinct elements that define the project, five metal steles that will each be of three sleeves of metal casings, making use of historical patination, four seats that take alchemaic and masonic marks found in Lincoln Cathedral and Boston Stump, and will be hewn from charred oak, and the listening post of parabolic mirror form and reflection settle makes it possible to have a whispered conversation across the old River Witham. The settle or shield wall is a concave structure set in front of the steles, the wall is pierced with designs taken directly from the arrow flight windows at Tattershall Castle. This pays reference of the extraordinary concrete structures built at Dungeness built to listen for aircraft activity from across the channel between the two great wars. The area immediately around the sculptural forms will be landscaped to bring focus to the surrounding area.

To conclude, the project has been developed from long term study of the Lincolnshire landscape and the memory of Lincolnshire's past in its richness of its history and its myth. The route between Lincoln and Washingborough will have a quite place within which to enjoy and experience a particular part of its landscape. The ideas for this scheme have been tested at public exhibition, on three occasions in North Kesteven and there has been positive feedback from local people, school children, musicians, dance groups, local councillors and planners. It is our intention to hold a workshop at the site of the finished work and to test audience response over a period of a year.

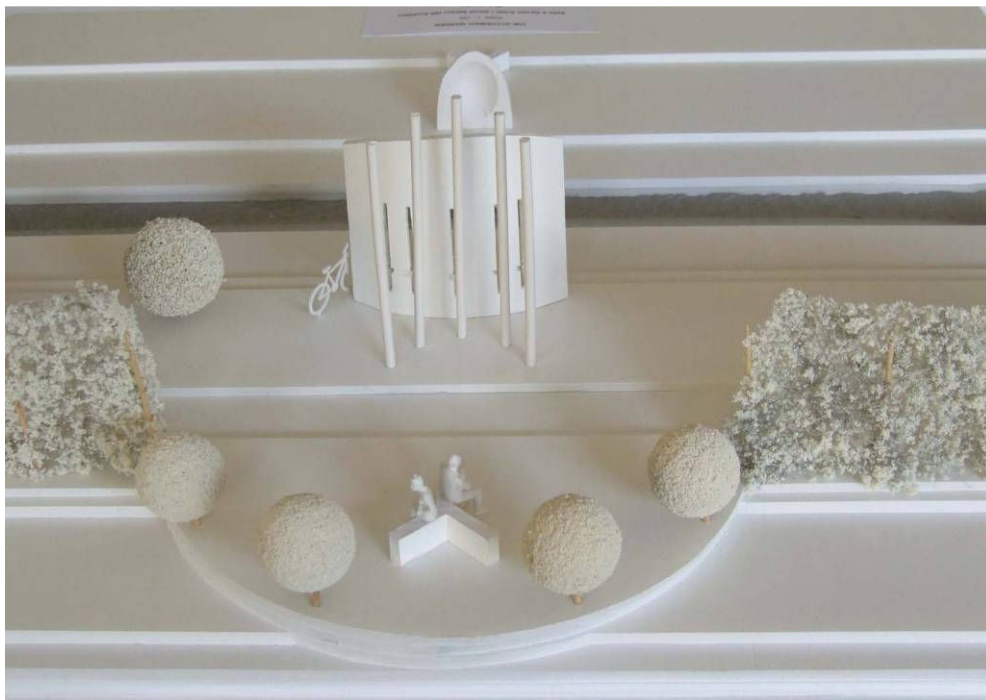

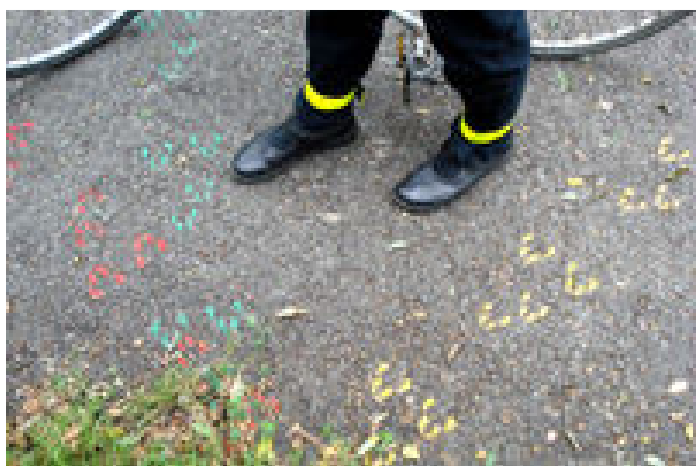
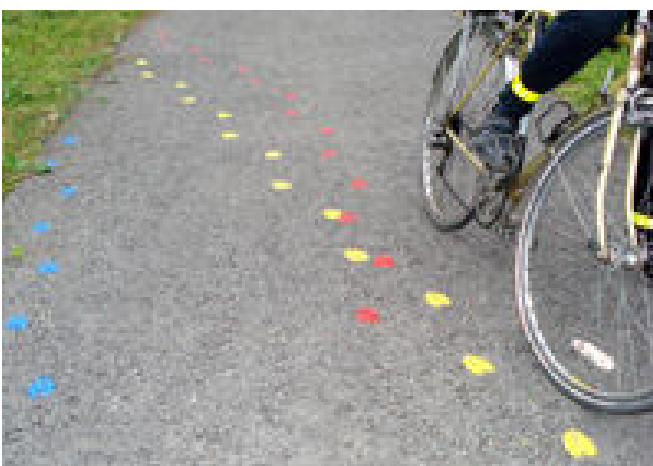
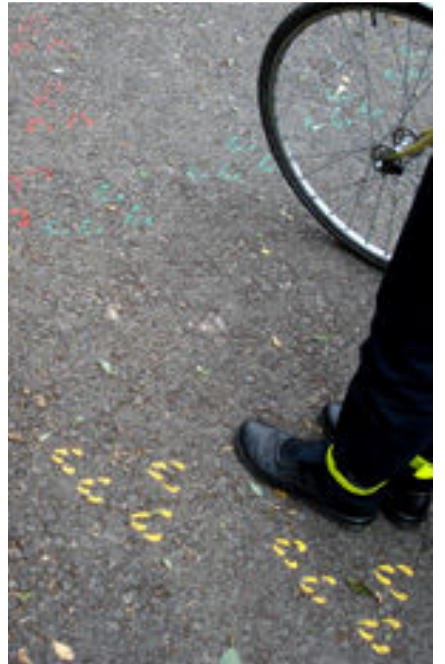
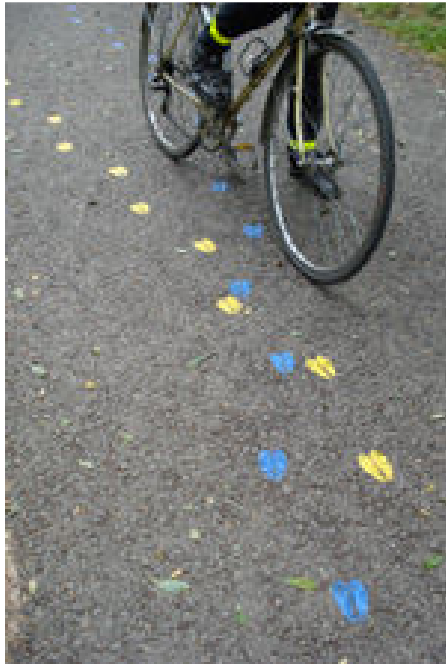
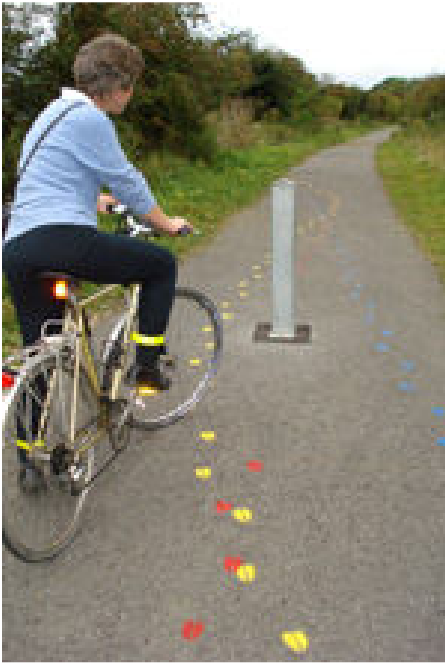

## **Paw Prints by Nicola Jones**

Watger rail Way national Cycle Network Route 1 - Between Bardney and Woodhall Spa

# How cyclists' two towers will rise above landscape to show the route ahead

**TOWERS with panoramic views of the countryside are to be built at either end of a cycle path linking Lincoln and Boston.**

The eight-metre-high structures, costing £190,000, will offer unique vantage points across the county.

The Lincoln tower will be situated near Beech House in Waterside South while its Boston twin it will be built near the Witham Business car park.

The towers are part of the Hi-Views project commissioned by Sustrans - a sustainable transport charity.

The charity's aim is to enhance either end of the National Cycle Network Route One.

Last year Sustrans organised a competition to design the towers and drafts by Belgian architect Paul Robbrecht were chosen.

Lincoln-based architect Stephen Palmer (49), who is assisting with the project, said: "The towers are a cross between a work of art or sculpture and a formal building."

"Both structures are based around the central premise of a staircase with a viewing

point. But they are both very different.

Henry Killworth  
[henry.killworth@lincolnshireecho.co.uk](mailto:henry.killworth@lincolnshireecho.co.uk)

"Lincoln's tower reflects Boston and Boston's reflects Lincoln."

Towards the end of last year Mr Robbrecht visited Lincolnshire to gather ideas for the two designs.

Mr Palmer said: "The Boston viewing point is based around the irregular vaulting in Lincoln Cathedral.

"It is dubbed the Boston Pendulum and the staircase is zig-zag in shape."

"The Lincoln tower draws on the imagery inside the Boston Stump - it features a cage-like structure. It has been dubbed

the Lincoln Stump and gives a feeling of being inside looking outside."

Both structures will be situated near to the banks of the River Witham and will be painted in colours inspired by birds nesting in the area.

Sustrans spokesman Gill Harrison said: "The towers will complement the existing cycle route and give walkers and cyclists the chance to take a break."

"Lincolnshire is characterised by large, beautiful, flat expanses of land - the towers will give people a different view of Lincolnshire."

The project is supported by the Lincolnshire Public Art Network, Lincoln City Council and the Arts Council for

England - East Midlands.

Ms Harrison said: "These towers are phase one of the project."

"We are planning two further viewing platforms along the route."

Bardney and Woodhall Spa, near Lincoln, have been earmarked as locations for the two towers along the route.

Subject to planning consent and funding bids, phase two is planned to start in January.

A planning application for the Lincoln tower has been submitted to the city council.

Meanwhile, the Boston proposal has also been put before planners. Both applications are being considered and if they are successful the towers could be started in the autumn and completed by next spring.

City council principal planning officer Pete Harness said: "I would like Lincolnshire Police to look at the isolated site. It might attract unsuitable people - we want to make sure it's safe."

What do you think about the two towers? Write to Your View, Lincolnshire Echo, Brayford Wharf East, LN5 7AT.

Or e-mail [yourview@lincolnshireecho.co.uk](mailto:yourview@lincolnshireecho.co.uk).

■ **The National Cycle Network** currently provides 8,000 miles of cycling and walking routes across Britain.

■ **One third of the network is on paths which are free from motor traffic.**

■ **The rest uses**

## IN THE KNOW

quiet lanes or traffic-calmed road in towns and cities.

■ **The network is split into six national routes.**

■ **Lincolnshire is**

part of national route 1 which goes from Dover up the east coast to Edinburgh.

■ **The Lincoln to Boston section is in a sub-route which goes from Hull to Norfolk.**

■ **By 2005 the network will cover 10,000 miles.**

# Routing around

News and views on cycle route developments by Richard Peace

## NEW ROUTE DEVELOPMENTS Staffordshire

The Chase Heritage Cycle Trail will run between Cannock, Hednesford and Rugeley. It will offer a safe route across Cannock Chase and access to attractions such as Rugeley Chancel Ruins, the Ironworks site at Slitting Mill and Cannock Chase itself, with spurs off to the visitor centres at Birches Valley, Marquis Drive and the Museum of Cannock Chase. The route will be signed and will have distance posts and information boards, with some new traffic signals and toucan crossings already having been installed. It will link into National Cycle Network Route 5 which runs from Reading up through Birmingham to Chester and then along the North Wales coast to Holyhead. Work is expected to be complete by Spring 2008.

being a bottleneck in the National Cycle Network for a number of years – an extension of the Greenway into Victoria Park at Oakenshaw and on to Low Moor leads to a signposted route, part purpose-built paths and part quiet roads, to the city centre. Further improvements are planned, but the centres of Huddersfield, Dewsbury and Bradford are now connected for cyclists.

There is much work involved in restoring sections of The Trans Pennine Trail following the floods earlier this year. A bridge near Old Moor in South Yorkshire was swept off its supports and may not be back in place yet – diversions are available. There were problems in the Don Gorge and other places, in South Yorkshire particularly. But good things are happening as well:

where you can see the Northumberland fells, southern Scotland, the Solway Firth and North Sea. It offers a technically demanding 2km 'black route' detour. There is also a training loop near the trailhead by the car park at Kielder Castle. Leaflet available from Kielder Castle Forest Park Centre ☎ 01434 250209.

## ROUTE MAPS Wales

There is now an updated version of *Go Traffic Free in Wales* covering a route on Anglesey, one near Bangor, the Clydach Gorge route near Abergavenny and the Cardigan/Cilgerran cycle route in West Wales. It also covers country and forest parks with traffic-free routes. A new leaflet on the traffic-free Brunel Trail between Neyland Quay and Haverfordwest and a separate new one on Cardigan/Cilgerran are also available from Sustrans ☎ 0845 1130065 or downloadable from [www.sustrans.org.uk](http://www.sustrans.org.uk).

## Derby

A new and updated cycle map for Derby is available by calling ☎ 01332 715017 or can be picked up from local tourist information centres and libraries.

## Norway

Feeling adventurous? Sustrans has started selling four new map packs for long distance routes in Norway, two of them covering the North Sea Cycle Route, and all with English translations. £25 each. [www.sustransshop.co.uk](http://www.sustransshop.co.uk)

## Stroud

The *Stroud District Cycling Map* is another great cycling map from those people at [www.cyclecityguides.co.uk](http://www.cyclecityguides.co.uk) who have produced

over 125 such maps and guides for UK cities, towns and regions. Many their maps (although not this one), plenty of which are even downloadable for free, can be found on [www.lifecycleuk.org.uk](http://www.lifecycleuk.org.uk).

The Stroud map may look a little fuddy duddy from its cover, but the information inside is bang up to date with all the district's roads colour-coded for cycling difficulty – a rating based mainly on how heavy the traffic is that you'll find on them. The guides are based on OS maps, and are marked and listed with a wealth of information to enrich your ride. Everything from cafes to bike shops cycling organisations to local attractions, public transport links to libraries and sports centres!

The map can be ordered from [www.stroudvalleyscyclecampaign.org.uk](http://www.stroudvalleyscyclecampaign.org.uk) or ☎ 01453 822 451.

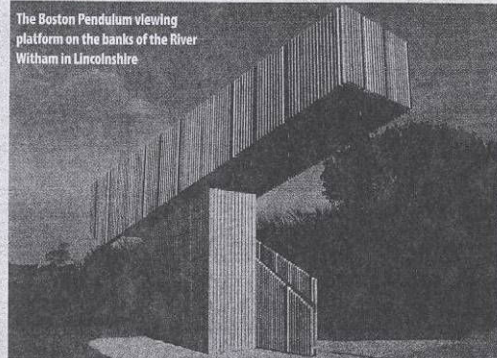

The Boston Pendulum viewing platform on the banks of the River Witham in Lincolnshire

## Lincolnshire

The Water Rail Way, part of NCN Route 1 and intended ultimately to link Lincoln and Boston, is now traffic-free for the 15 or so miles from Lincoln out to Kirkstead Bridge thanks to the opening of a section from Southrey to Kirkstead Bridge. Also, two 5 metre high viewing platforms may have been installed by now on the trail. Called 'The Lincoln Stump' and 'The Boston Pendulum', they will be on the banks of the River Witham and give dramatic countryside views of Lincoln Cathedral and the Boston Stump (St Botolph's Church, Boston). For a trail map, request the leaflet *Go with the Flow* from [www.visitlincolnshire.com](http://www.visitlincolnshire.com) or ☎ 01522 550613.

## Yorkshire

The Bradford end of The Spen Valley Greenway has been sorted out after

an improved new route through Leeds linking the TPT at the Royal Armouries to the Aire Valley towpath (signing may not yet be complete), a new cycle hire scheme in Penistone (☎ 01226 763373), a cracking new replacement Youth Hostel at Crowden (☎ 0870 770 5784) and three up-to-date maps published earlier this year – ☎ 01226 772574 or [www.transpenninetrail.org.uk](http://www.transpenninetrail.org.uk)

## Kielder Forest

The Forestry Commission claims to have developed the highest purpose-built off-road mountain bike route in England: 17km of singletrack trails around Kielder in Northumberland. Taking 18 months to build, they include a 15km route for bikers of moderate ability which takes in the Deadwater summit from

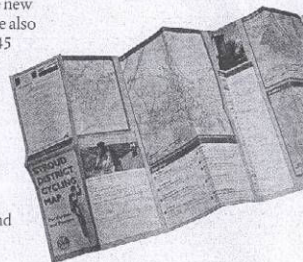

## INNOVATION London

A neat idea already operating in one or two parts of London is the bike shed (pictured below). Walthamstow Central station, Leyton and Leytonstone have them – not only is the bike shed locked and opened only with the use of a smartcard, your bike is locked to an individual post and can only be released using the same card. Hopefully this innovation will spread across the country.



# HTA China plans axed

Damian Arnold

A ground-breaking 12,000-home community in Shanghai designed by HTA and based on latest British "sustainable communities" thinking has been scrapped. In March, HTA won a design competition to masterplan a "model breaking" 100ha mixed-use development at the Phoenix City site on the Yangtze delta half an hour upstream from Shanghai.

It beat Wiel Arets from Netherlands and Takamatsu Architects from Japan, having been approached directly by the client, China's fourth largest housebuilder.

But after an intensive three-week design and model-building process, the practice was paid off by the client SunCo Shanghai Co and told that it was pursuing a more conventional design likely to be serialised across high-rise blocks. HTA envisaged more varied blocks of three to 15 storeys based

There was understood to be a growing interest among Chinese clients for sustainable housing design, which has led them to progressive British practices.

But HTA director Ben Derbyshire said that at Phoenix City, the client could not push through such a "radical departure" at the breakneck speed demanded while keeping within planning and building regulations.

"The jury liked our approach and wanted to break the mould," he said. "There is a growing air of unease in China concerning the effects of the regimented development of point blocks... They could see how we could animate a neighbourhood with the judicious juxtaposition of buildings, uses, access and movement, landscape and water."

"They wanted us to deliver it, and fast, while sticking strictly to the rules. As it turned out, the rules dictate the conventional approach."

Derbyshire added that the

## IN BRIEF

● **Starter's orders** David Morley Architects has won planning permission for an athletics training centre in north London and has also won £2 million in new funding for another new sports centre in Regents Park. The athletics centre in Pickers Lock will include a sprint track, an indoor athletics track and

changing facilities. The "sports hub" in Regents Park is a partially sunken circular cluster of changing rooms with a curving grass roof.

● **City housing approved** Sidel Gibson Architects has received planning permission for a housing scheme opposite Tate Modern in the City of London. The £12 million

scheme includes 67 flats as well as courtyard gardens, balconies and a riverside arcade. Construction is set to start in autumn next year.

## Pedal tower



Belgian practice Robbrecht & Daem has unveiled new images of its two sculptural viewing towers proposed for a national cycle path in Lincolnshire.

The two viewing towers, commissioned by Lincoln City Council with a budget of £200,000, are set for completion in October this year on the 30-mile cycle path between Lincoln and Boston. Pictured is the tower proposed for the Boston end of the route.

Last November the practice won its first major job in Britain beating Foreign Office Architects to a £10 million extension of the Whitechapel Gallery in east London. See Works pages 14-17.

FOR ALL HORIZONTAL ACCESS SOLUTIONS...  
FIT A BILCO

Bilco have the answer for all horizontal access situations - roof, floor, fire hatches and more - all engineered

7th May '04

# Plans for a tower beside cycle path

By James Hardaker

james.hardaker@jpress.co.uk

HERE is a sneak peek at the design for an eight-metre tower which could soon rise from the banks of the Witham.

Transport charity Sustrans has released this artist's impression of a structure set to be built in Boston beside a new cycle path if plans are given the go-ahead.

Belgian architect Paul Robbrecht, who conjured up designs for a pair of towers, said: "The project is situated on the two architectural poles – the starting and end points of the Lincoln-Boston cycling route."

The tower at this end of the path, known as The Boston Pendulum, will stand eight metres tall and offer views of the surrounding landscape all the way to St Botolph's Church.

A similar structure will be built at the other end, with the name The Lincoln Stump.

"The two viewing platforms are places where people can relax or meet while enjoying the Lincolnshire landscape," said Mr Robbrecht.

Together the towers will cost Sustrans £190,000 in a scheme backed by the Lincolnshire Public Art Network, Lincoln City Council and the East Midlands Arts Council for England.

The borough council has yet to approve plans for the Boston tower, which will be painted with colours inspired by the local bird life.

● LINCOLN man Roger Ingamells won a competition to name the cycleway, with the idea The Water Rail Path. The name combines the cycleway's location near a river and a railway line, as well as sightings along the path of a bird called the water rail.

● What do you think of the tower? Write to the Editor, Boston Standard, 5/6 Church Lane, Boston, PE21 6ND.

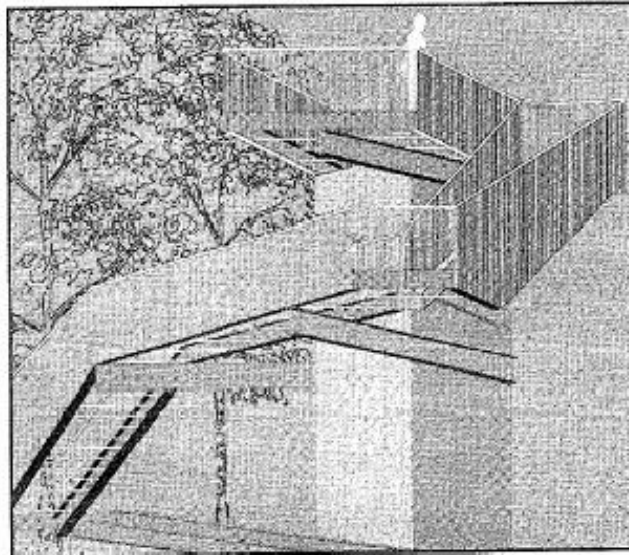

Tower power... An artist's impression shows how the proposed Boston Pendulum could look. NA