

# **Artist Brief for Bartholomew Square, Brighton: Alleyway enhancement**

## **The Brief**

**Location:** Bartholomew Square, Brighton: Alleyway enhancement

**Budget:** £14 000

**Date:** June 2011

An art commission is offered to transform the alleyway linking Bartholomew Square to Black Lion Street into a **safe, attractive and inviting gateway** between the square and the sea. The commission is **for a creative vision and practical realisation** and there is the opportunity to incorporate surface treatments and lighting installation to fulfil the brief.

The commission is being offered by Brighton & Hove City Council as part of the environmental improvement of Bartholomew House. This will ensure that council services are more welcoming and accessible to our service users. As part of this project, the council has identified an opportunity to improve and enhance Bartholomew Square and in particular to improve the gateways to the Square.

This call for artistic ideas will be in two phases: an initial expression of interest and then a shortlist of four artists will be selected who will be invited to make a fuller proposal.

## **The Commission**

### **Aims**

It is intended that the artist's intervention/ art work will:

- Provide an attractive gateway into the square from the street and vice versa
- Increase use of the alleyway as a thoroughfare by improving the experience for users
- Make the space safer and feel perceptively safer for visitors and users
- Deter the use of the space for anti-social behaviour
- Become a feature and destination in its own right through being a bold and innovative public artwork.
- Signal a design approach and set a standard that could be rolled out to the rest of the Square.
- Be durable, robust and low maintenance

### **Artist's Role**

The artist will need to take a collaborative approach to realising and installing their design with:

Nigel McCutcheon, Architect and Design Consultant, Property & Design, BHCC- regarding integration and enabling requirements and technical

parameters including lighting opportunities and limitations and in the final installation.

The artist is responsible for arranging and installing, or managing the installation of the final art work.

The artist will be required to provide a cleaning and maintenance manual for the artwork, and to provide advice on any future issues that might arise from the artwork.

The artist agrees to participate in any press activity relating to the project including attendance at a launch event or press call if necessary.

### **The Site**

The artwork will be located in the alleyway that runs from Black Lion Street to Bartholomew Square. This is a public thoroughfare that is open day and night.

The artwork should cover the walls and ceiling of the alleyway. There is the potential for the artwork to reach out on to Black Lion Street to increase visibility from the seafront. The design must incorporate lighting: either integrated as part of the artwork or with provision to be installed separately.

The alleyway has the potential to provide a convenient route from the Square to the seafront. However currently the alleyway is rundown, unwelcoming and has both low visibility and poor legibility.

The alleyway has a multitude of confusing signage, which will be removed before the artwork installation. There are also three alcoves, which can be either incorporated into the design or blocked up.

The space also has some inherent difficult features and functions that the artwork must accommodate. The alleyway houses fire exits from the car park and from neighbouring properties, which remain in use. It also accommodates the current store-room for Moshi Moshi and a ventilation grate.

The artwork should respond to the findings and recommendations of the legibility report for Bartholomew Square (Appendix 2)

### **Budget and fee payment instalments**

The budget for this art-work is £14000 to include all artist fees, fabrication and installation.

Additional budget is earmarked for lighting which could be incorporated into the artist's proposal following discussion with the project manager.

The above fee does not include VAT, which will be added where the artist is VAT registered.

The fee includes all travel, accommodation, material and expenses incurred by the Artist.

Shortlisted artists will be expected to present an initial budget breakdown as part of their submission: a detailed budget breakdown on appointment and a statement of expenditure at the end of the project.

The fee will be paid in instalments on receipt of invoices, with 10% retained until after final installation and sign off. The payment schedule will be agreed with the selected artist.

### **Timetable**

Artist brief issued	21 June
Closing date for expression of interest	30 June
Shortlisted artists notified	1 July
Shortlist artist interviews	27 July
Final artist appointed	28 July
Detailed design and production manual complete	mid-August
Installation	Aug/Sept.
Launch	mid-Sept.

### **Design requirements**

#### **Sustainability**

We require a statement about the sustainability of the materials to be used in the artwork.

#### **Maintenance**

The work must be durable, robust and appropriate for the public realm with the potential for both periods of high pedestrian traffic and of little or no observation. It should be easily cleanable as part of the general maintenance of the square and surrounding streets. The selected artist will be required to provide a maintenance and operations manual for their artwork.

We would expect the artwork to have a life span of at least 10 years.

#### **Accessibility**

The artwork should be DDA compliant and access requirements should be considered in the design process.

#### **Crime & Disorder**

This alleyway is not over-looked by any businesses or residences and consequently has a history of being used for anti social activities particularly drug-taking, dealing and alcohol abuse. The design should attempt to make the area more visible and therefore less attractive to this type of activity.

## **Health & Safety**

The appointed artist will be required to produce full risk assessments for the design and for the installation of the artwork.

## **Decommissioning**

The artist will consider in the design of the artwork how the artwork may be dismantled should there be a requirement at a future date to decommission the piece.

## **Process**

### **Management**

The commission process will be managed by the Arts & Cultural projects team in the Culture Commissioning Unit at Brighton & Hove city council.

The technical and practical installation will be managed by Nigel McCutcheon.

### **Selection Panel**

The selection panel for the artwork in both the shortlist and the final selection phase will consist of representatives from:

- Arts and Cultural projects
- Environmental Improvements
- Thistle Hotel
- Moshi Moshi
- Inn Brighton

### **Phases**

Selection will be through a two phase process:

1. Artists are invited to submit an expression of interest, an artist statement and evidence of previous relevant work, including images where appropriate.

Deadline: 5pm Thursday 30 June 2011

Notification: By 5pm Friday 1 July 2011

Please note that only shortlisted artists will be notified.

Please do not include any suggested designs for the commission, any expression of interest that does so we will have to disregard.

Should you wish any material returned to you please include a self addressed envelope and indicate which items to return.

Please post your expressions of interests to:

James Halliday,  
Brighton and Hove City Council,  
Arts and Culture,  
Kings House,  
Grand Avenue,  
Hove,  
BN3 2LS

Unfortunately we cannot accept emailed expressions of interest.

2. A maximum of five shortlisted artists will be invited to interview and provide a detailed proposal for the site in response to the details in this brief.

This will include:

- A worked up idea
- Visual representations and images
- Example of materials
- An initial maintenance statement
- An initial expenditure breakdown
- An initial method statement for installation

A contribution towards expenses of £250 per artist will be made.

Interviews take place on: Wednesday 27 July

Installation to be complete by Mid-September 2011

Any questions concerning the commission please contact:

James Halliday Assistant Arts Officer: [james.halliday@brighton-hove.gov.uk](mailto:james.halliday@brighton-hove.gov.uk)

# Images

Alley site plan:

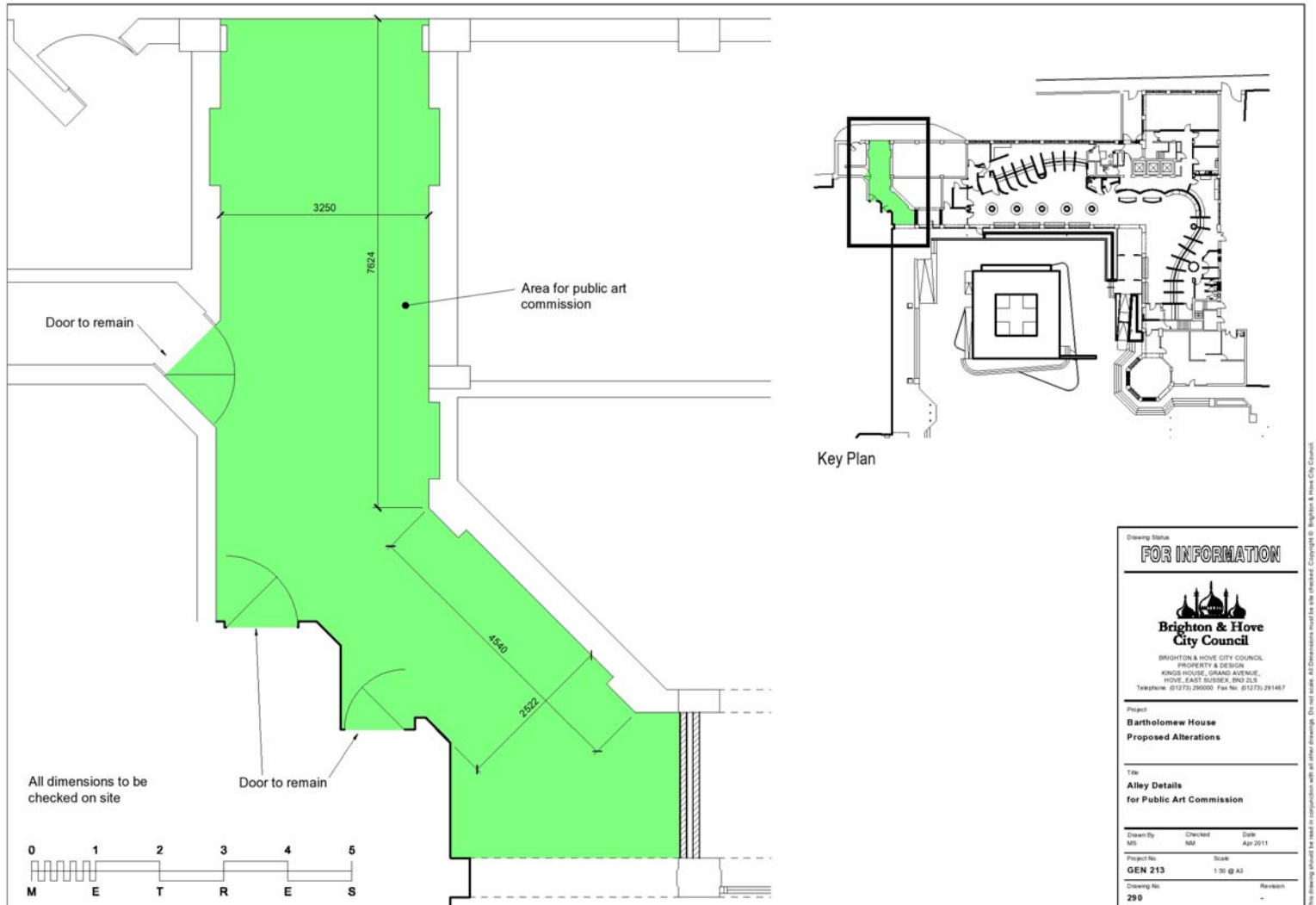

Bartholomew Square from west side facing east:



Bartholomew Square from the east side facing west:





Entrance of alley viewed from Bartholomew Square:



Entrance to alley from Black Lion St:





Looking into alley from Bartholomew Square:



Looking through alley from Black Lion St:



Looking out from alley towards Bartholomew Square:



Looking out from alley towards Black Lion St:



2 alcoves on right looking towards Black Lion St:

